

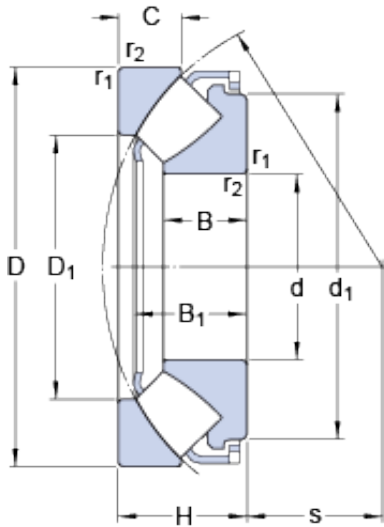

NTN DRIVESHAFT ANDERSON, INC.



120 mm x 250 mm x 50.5 mm SKF 29424 E
thrust roller bearings

Bearing No. 29424 E

29424 E Bearing 2D drawings and 3D CAD models

Size	250x120x78 mm
Bore Diameter	250 mm
Outer Diameter	120 mm
Width	78 mm
d	120 mm
D	250 mm
H	78 mm
d ₁	216 mm
D ₁	171 mm
B	50.5 mm
B ₁	70.3 mm
C	36.5 mm
s	74 mm
r _{1,2} - min.	4 mm
d _a - min.	180 mm
d _{b1} - max.	132 mm
d _{b2} - max.	142 mm
D _a - max.	209 mm
r _a - max.	3 mm
Basic dynamic load rating - C	1370 kN
Basic static load rating - C ₀	3450 kN
Fatigue load limit - P _u	375 kN
Reference speed	1500 r/min
Limiting speed	2600 r/min



NTN DRIVESHAFT ANDERSON, INC.

Factor min. axial load - A	1.1
Category	Thrust Roller Bearing
Inventory	0.0
Manufacturer Name	SKF
Minimum Buy Quantity	N/A
Weight / Kilogram	17.52
EAN	7316576609091
Product Group	B04311
Rolling Element	Spherical Roller Bearing
Self Aligning	Yes
Component Description	Roller Assembly plus Raceways
Thrust Bearing	Yes
Single or Double Direction	Single Direction
Banded	No
Cage Material	Steel
Precision Class	ABEC 1 ISO P0
Other Features	Single Row Window Type Cage
Long Description	120MM Bore 1; 171MM Bore 2; 250MM Outside Diameter; 78MM Height; Spherical Roller Bearing; Single Direction; Self Aligning; Not Banded; Steel Cage; ABEC 1 ISO P0; Roller Assembly plus Raceways
Inch - Metric	Metric
Category	Thrust Roller Bearings
UNSPSC	31171507
Harmonized Tariff Code	8482.30.00.40
Noun	Bearing
Keyword 3	Spherical
Keyword String	Thrust Roller Spherical



NTN DRIVESHAFT ANDERSON, INC.

Manufacturer URL	http://www.skf.com
Manufacturer Item Number	29424 E
Weight / LBS	38.581
Overall Height with Aligning Washer	0 Inch 0 Millimeter
Bore 1	4.724 Inch 120 Millimeter
Height	3.071 Inch 78 Millimeter
Outside Diameter	9.843 Inch 250 Millimeter
Bore 2	6.732 Inch 171 Millimeter
bore diameter:	120 mm
operating temperature range:	Maximum of +392 ° F
outside diameter:	250 mm
maximum rpm:	2600 RPM
overall width:	78 mm
separable type:	Non-Separable
cage material:	Steel
fillet radius:	3 mm
static load capacity:	3450 kN
series:	294
dynamic load capacity:	1370 kN
d_1	216 mm
D_1	171 mm
B_1	70.3 mm
$r_{1,2}$ min.	4 mm
d_a min.	180 mm
d_{b1} max.	132 mm
d_{b2} max.	142 mm
D_a max.	209 mm
r_a max.	3 mm
Basic dynamic load rating C	1370 kN
Basic static load rating C_0	3450 kN
Fatigue load limit P_u	375 kN



NTN DRIVESHAFT ANDERSON, INC.

Minimum axial load factor A	1.1
Mass bearing	17.5 kg