

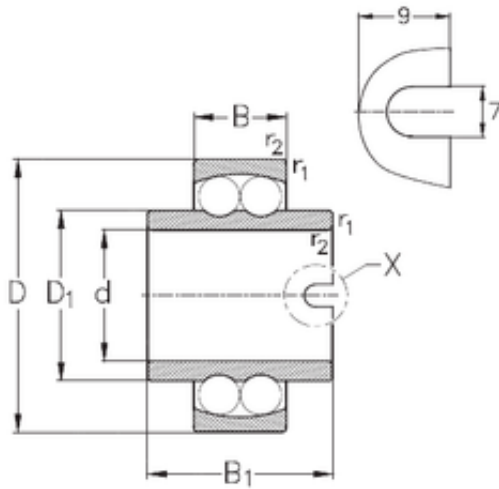

NTN DRIVESHAFT ANDERSON, INC.

30 mm x 72 mm x 52 mm NKE 11306 self aligning ball bearings



Bearing No. 11306

Size	30x72x52 mm
Bore Diameter	30 mm
Outer Diameter	72 mm
Width	52 mm
d	30 mm
D	72 mm
B	52 mm
C	19 mm
r1 min.	1,1 mm
r2 min.	1,1 mm
D1	45 mm
Weight	0,64 Kg
Basic dynamic load rating (C)	21,6 kN
Basic static load rating (C0)	6,3 kN

11306 Bearing 2D drawings and 3D CAD models