

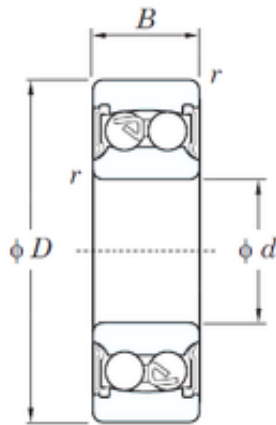

NTN DRIVESHAFT ANDERSON, INC.

40 mm x 90 mm x 33 mm KOYO 2308-2RS self aligning ball bearings



Bearing No. 2308-2RS

Size	40x90x33 mm
Bore Diameter	40 mm
Outer Diameter	90 mm
Width	33 mm
d	40 mm
D	90 mm
B	33 mm
C	33 mm
r min.	1.5 mm
da min.	48.5 mm
da max	49.6 mm
Da max.	81.5 mm
ra max.	1.5 mm
Weight	0.925 Kg
Basic dynamic load rating (C)	29.5 kN
Basic static load rating (C0)	9.70 kN
(Grease) Lubrication Speed	4600 r/min
Calculation factor (e)	0.25
Calculation factor (Y0)	2.69
Calculation factor (Y1)	2.57

2308-2RS Bearing 2D drawings and 3D CAD models