

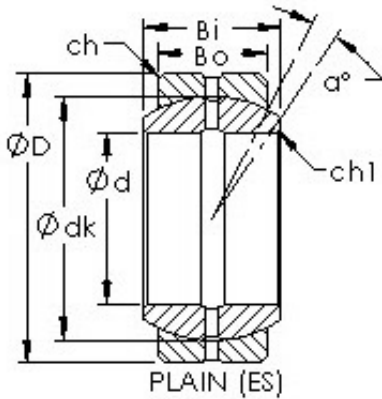

NTN DRIVESHAFT ANDERSON, INC.



AST GEF50ES plain bearings

Bearing No. GEF50ES

Bore Diameter	50 mm
Outer Diameter	80 mm
Bearing Type - plain-wide	plainwide
Bore Dia (d)	50.0000
Outer Dia (D)	80.0000
Outer Width (Bo)	36.0000
Inner Width (Bi)	42.0000
Dynamic Load Rating (Cr)	220,000
Static Load Rating (Cor)	1,100,000
Max. shaft corner radius, or 45 deg. chamfer (ch1)	1.000
Max. housing corner radius, or 45 deg. chamfer (ch)	1.000
Spherical Diameter (dk or Dk)	72.000
Mis-alignment Angle (a deg.)	5
Weight (g)	885.00
Material	52100 Chrome steel, or equivalent

GEF50ES Bearing 2D drawings and 3D CAD models