

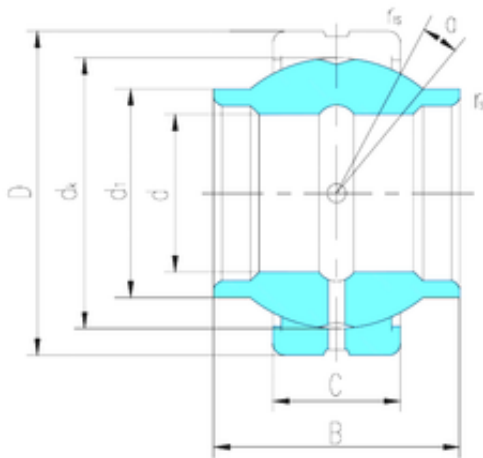

# NTN DRIVESHAFT ANDERSON, INC.



60 mm x 90 mm x 54 mm LS GEEM60ES-2RS  
plain bearings

Bearing No. GEEM60ES-2RS

Size	60x90x54 mm
Bore Diameter	60 mm
Outer Diameter	90 mm
Width	54 mm
d	60 mm
D	90 mm
B	54 mm
C	36 mm
d1	68 mm
dk	80 mm
r min.	0,6 mm
r1 min.	1 mm
Angle	3 °
Weight	1,06 Kg
Basic dynamic load rating (C)	245 kN

GEEM60ES-2RS Bearing 2D drawings and 3D CAD models