

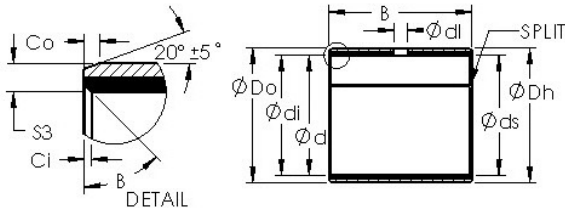

NTN DRIVESHAFT ANDERSON, INC.



AST AST50 108IB72 plain bearings

Bearing No. AST50 108IB72

Bore Diameter	171,45 mm
Bearing Type	straight
Shaft Dia., Nominal (d)	6.7500
Shaft Size (ds) - 6.75	6.7475
Housing Bore Dia. (Dh) - 6.9374	6.9358
Bearing Bore after Mounting (di) - 6.757	6.7502
Average Clearance (Cd)	0.0048
Wall Thickness (S3)	0.095
Bearing Length, Nominal (B)	4.500
Bearing Length Tolerance (B tol.) - +.010 / -0.010	+.010 / 0.010
OD Chamfer Length (Co)	0.072
ID Chamfer Angle (B deg.)	30
ID Chamfer Length (Ci)	0.031
Material	Carbon steel shell with PTFE / Fiber lining

AST50 108IB72 Bearing 2D drawings and 3D CAD models