

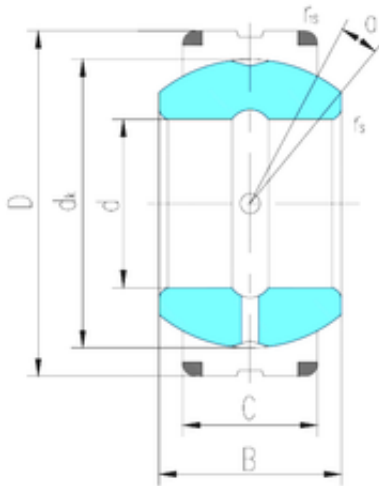

NTN DRIVESHAFT ANDERSON, INC.



460 mm x 620 mm x 218 mm LS GEC460XS
plain bearings

Bearing No. GEC460XS

Size	460x620x218 mm
Bore Diameter	460 mm
Outer Diameter	620 mm
Width	218 mm
d	460 mm
D	620 mm
B	218 mm
C	185 mm
dk	540 mm
r min.	1,5 mm
r1 min.	4 mm
Angle	3 °
Weight	204 Kg
Basic dynamic load rating (C)	9000 kN

GEC460XS Bearing 2D drawings and 3D CAD models