

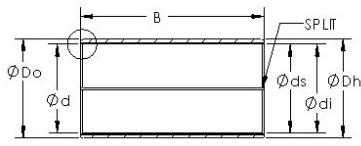

# NTN DRIVESHAFT ANDERSON, INC.

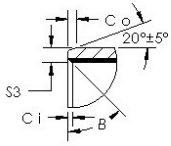

## AST AST850SM 3840 plain bearings

Bearing No. AST850SM 3840

AST850SM 3840 Bearing 2D drawings and 3D CAD models

Bore Diameter	38 mm
Outer Diameter	42 mm
Bearing Type	metal with bronze and graphite
Shaft Dia., Nominal (d)	38.0000
Shaft Size (ds) - 38 +0 / -0.039	38 +0 / 0.039
Housing Bore Dia. (Dh) - 42 +0.025 / -0	42 +0.025 / 0
Bearing Outside Diameter, Nominal(Do)	42.000
Bearing Bore after Mounting (di)	38 +0.185 / +0.040
Average Clearance (Cd)	0.1320
Wall Thickness (S3)	1.950
Bearing Length, Nominal (B)	40.000
Bearing Length Tolerance (B tol.) - +0 / -0.40	+0 / 0.40
OD Chamfer Length (Co)	1.200
ID Chamfer Angle (B deg.)	35
ID Chamfer Length (Ci)	0.500