

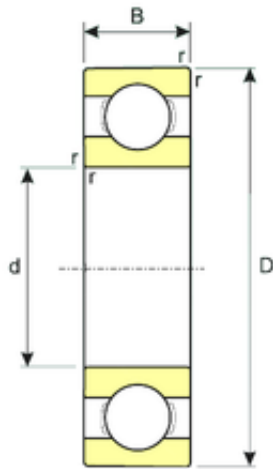

NTN DRIVESHAFT ANDERSON, INC.

3,175 mm x 9,525 mm x 3,967 mm ISB R2 deep groove ball bearings



Bearing No. R2

Size	3.175x9.525x3.967 mm
Bore Diameter	3,175 mm
Outer Diameter	9,525 mm
Width	3,967 mm
d	3,175 mm
D	9,525 mm
B	3,967 mm
C	3,967 mm
r min.	0,3 mm
Basic dynamic load rating (C)	0,49 kN

R2 Bearing 2D drawings and 3D CAD models